



*Codesign ,moulds project, Master models and moulds for
plastiic , Polyurethane and p-DCPD object)
Since 1975*



ci/esse

Via Marsala, 34 - 20052 Monza (Mi) ITALY
Tel. :+39/039/2007881
Fax :+39/039/2006145
Web : www.ci-esse.com
E-mail : l.antonelli@ci-esse.com

ci/esse
di Antonelli Giancarlo



*Design and manufacture of models, moulds and equipment for
plastic, polyurethane and p-DCPD parts*

THE HISTORY

Our company was founded in 1975 and it is specialized in the project and construction of moulds and equipments for thermoplastic, polyurethane and PDCPD pieces. The production is guaranteed by the 40 years experience of the owner and founder, Mr. Giancarlo Antonelli and of highly qualified personnel. In a market, where everything is based on costs, quantities and efficiency to reach the TIME TO MARKET of the final product, our society since the beginning of the 1990, has centred the production on markets with particular demands, in order to be flexible in different applications.

In fact the moulds we supply are in:

- Aluminium moulds CAD CAM worked
- Steel moulds CAD CAM worked
- Casting kerite moulds CAD CAM worked
- Casting aluminium moulds CAD CAM worked
- Epoxide resin moulds
- Ureol models CAD CAM worked
- Polystyrene and low density Polyurethane models , CAD CAM worked
- Prototypes for tests

Our moulds are suitable for press machines or with self equipments , from small to large dimensions.

All moulds are project and worked with CAD CAM technology , using Pro- Engineer CAD 3D system for mathematical models and CAM WorkNC to lead the NC machines.

Our moulds satisfied different technologies of moulding, such as injection plastic, vacuum forming, twin sheet moulding, low and high density Polyurethane, PU-RIM , PDCPD , RTM, blow moulding, rotation moulding, etc.

Our main sectors are:

- Dental and electro medical
- Digging machines , tractors , trucks and automotive in general
- After market and prototype car parts
- Tuning
- Coffee machines and Vending
- Furniture
- Scales and technical articles in general

The society has nr.2 production units , the first with interior 1800 square meters, plus exterior 800 square , the second with interior 2000 square meters, plus exterior 400 square meters.



ci/esse

Via Marsala, 34 - 20052 Monza (Mi) ITALY

Tel. : +39/039/2007881

Fax : +39/039/2006145

Web : www.ci-esse.com

E-mail : l.antonelli@ci-esse.com

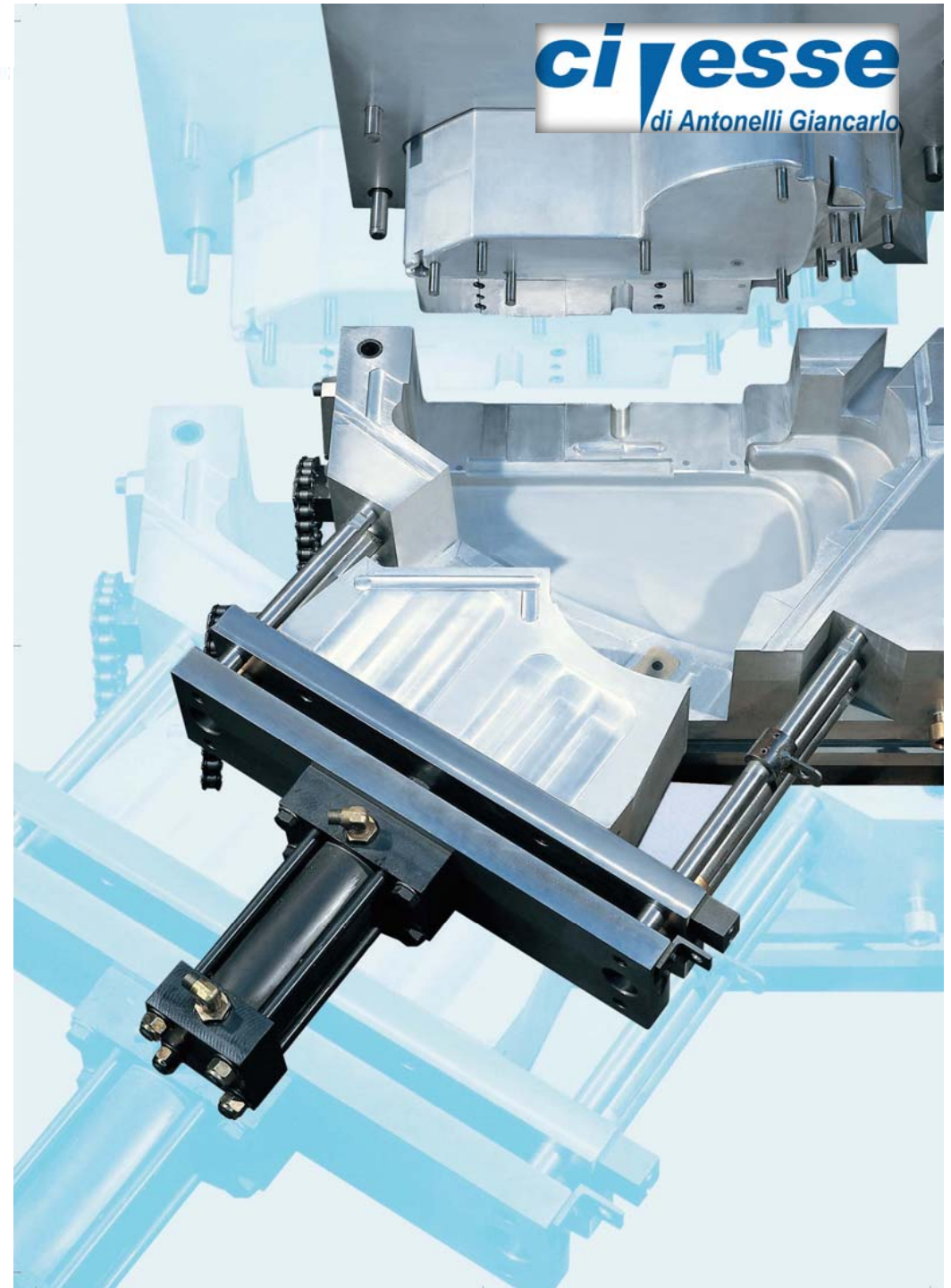

Codesign , Design, Analysis 3D

In order to satisfy our customers requests with the arrival in the society of the Eng. Lorenzo Antonelli, the son of the founder, new service of design, co-design, reverse engineering, prototyping and analysis have been introduced.

In particular our CO-DESIGN service can start from your ideas to their realizations. Due to our know how, in this way is possible to reach the construction of the mould and the final piece without waste of important time and further costs of investments, that happens when starting projects are not suitable.

Starting from your 2D project, your exterior surface 3D, from your idea or from an already existing physical piece (REVERSE ENGINEERING), we can directly create the final executive 3D.

Together with our customers we study the best technology useful to develop the product, either in quality, either in time tables and costs, and all the engineering with thickness, ribs ect.

We have started 3D modelling in 1990, with the first CAD 3D work station, adding a second one in 1995 and a third one in 2000, leaded by highly qualified personnel.

We use CAD 3D Pro - Engineer for modelling and design and Autocad for drawings in CAD 2D.

We have worked in CO-DESIGN to realize injection plastic, polyurethane, rub and telene (DCPD) components, suitable for many technologies.

Our experiences have been different in many sectors , such as automotive, tuning, furniture, electro medial, electronic, interior design, digging machines, trucks, tractors, dental and all general technical articles.

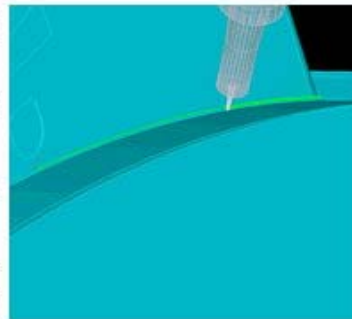
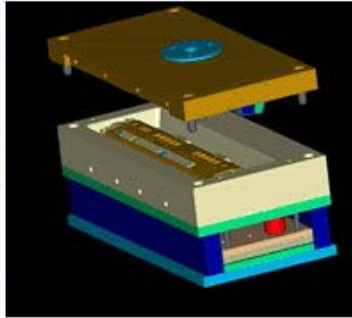

ci/esse
di Antonelli Giancarlo

ci/esse

Via Marsala, 34 - 20052 Monza (Mi) ITALY

Tel. : +39/039/2007881

Fax : +39/039/2006145

Web : www.ci-esse.com

E-mail : l.antonelli@ci-esse.com

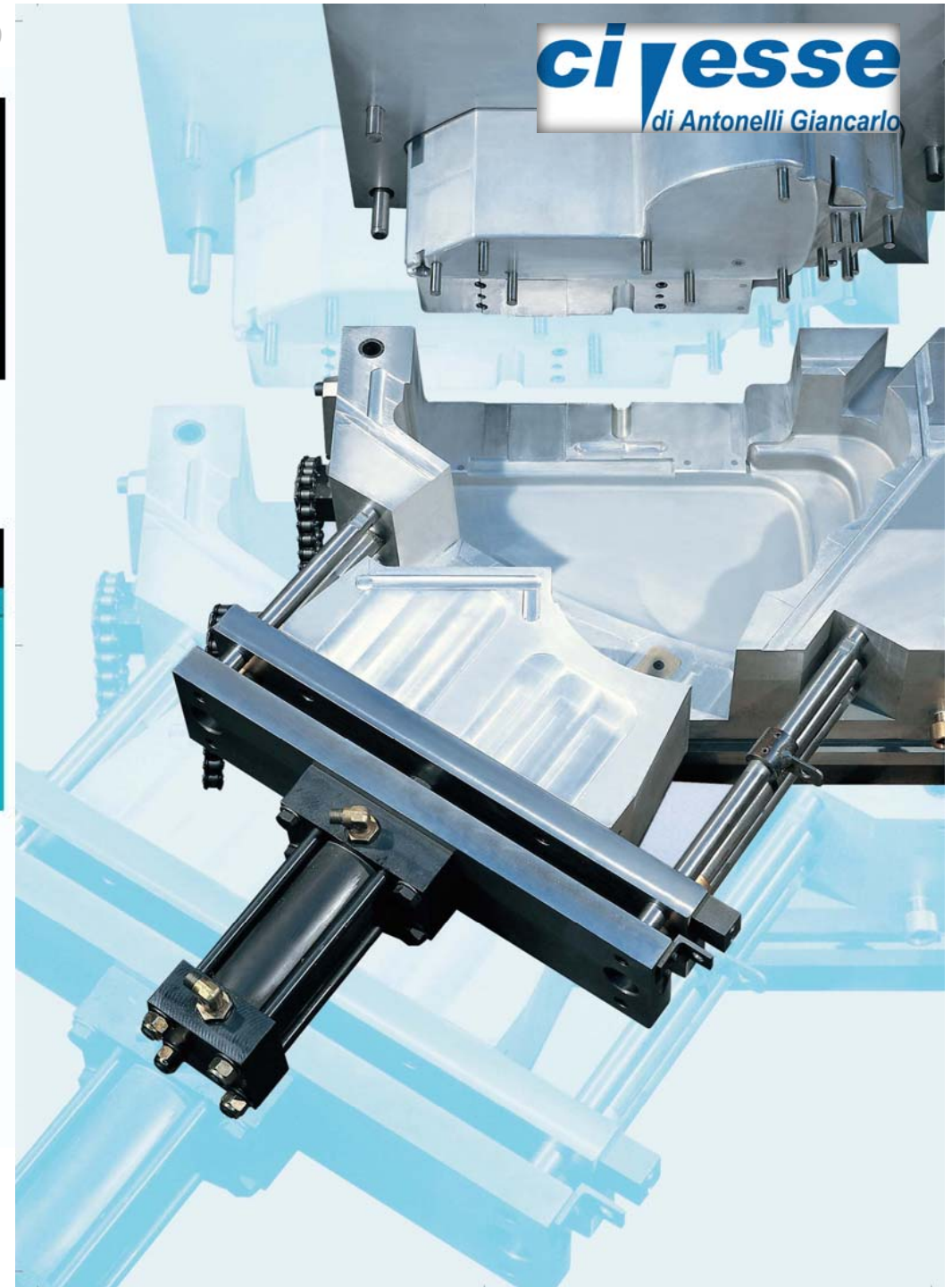

CAD / CAM / CAE resources

CAD

Nr.2 Workstation DELL Precision 370 with installed Pro/Engineer WildFire 2
(Parametric Technology Corporation)



CAM

Nr.1 Workstation Worknc (Taglio)



Interface 3D

IGES - VDA - CATIA. model - STEP - prt (Pro/E format)

Interface 2D

IGES - DXF - DWG

Operative System

Windows Xp Professional - Windows 2000 Professional - Windows 98



ci/esse

Via Marsala, 34 - 20052 Monza (Mi) ITALY

Tel. : +39/039/2007881

Fax : +39/039/2006145

Web : www.ci-esse.com

E-mail : l.antonelli@ci-esse.com

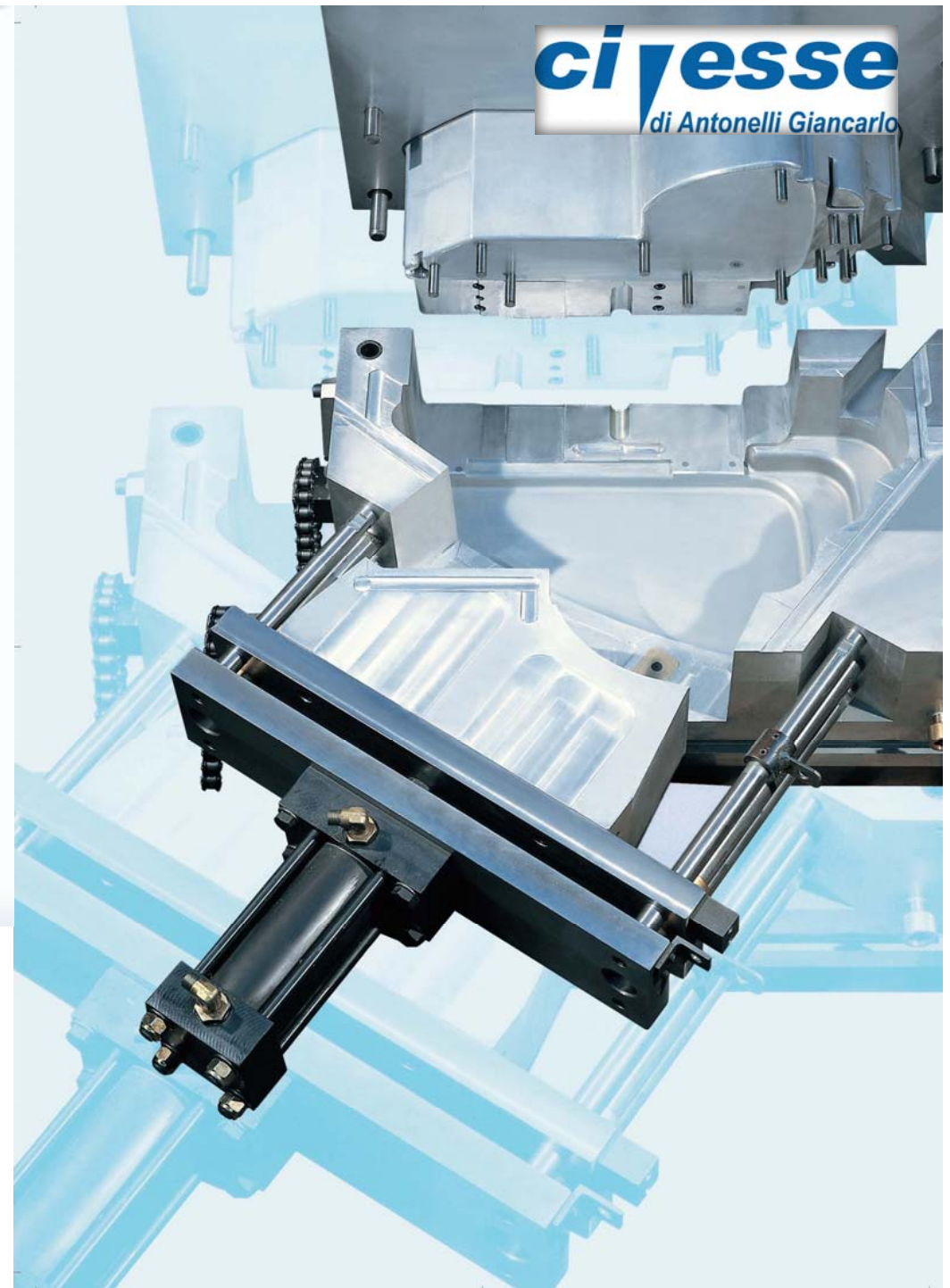

MACHINES

- Nr.1 NC Milling machine HSM 5 axis Stark 4 Fidia
(working size) mm 2600 x 1800 x 1000
- Nr.1 NC Milling machine HSM 5 axis Fidia GT1710
(working size) mm 3000 x 1700 x 1000
- Nr. 1 NC Milling machine FTP Sirio NC Selca 3045
(working size) mm 6000 x 1200 x 2000
- Nr. 1 NC Milling machine Parpas BF-120
(working size) mm 3500 x 1200 x 1000
- Nr. 1 NC Milling machine Parpas HP 90
(working size) mm 2500 x 1200 x 1000
- Nr. 1 NC milling machine FTP Speedy NC Selca 3045 digital
(working size) mm 3000 x 1200 x 1200
- Nr. 1 NC Milling machine Parpas ML 90
(working size) mm 4000 x 1850 x 1000
- Nr. 1 NC Milling machine Parpas ML 100
(working size) mm 4000 x 2000 x 1000
- Nr. 1 NC milling machine NOMO NC Selca 1200
(working size) mm 2200 x 700 x 1000
- Nr. 1 Bench milling machine NOMO
(working size) mm 2200 x 700 x 1000
- Nr.1 Universal milling machine NOMO
(working size) mm 900 x 300 x 500
- Nr. 1 Universal milling machine CERNOTTO
(working size) mm 900 x 400 x 500
- Nr. 1 Spark Erosion CDM
(working size) mm 1300 x 1000 x 1000
- Nr. 1 NC drilling machine Foratrice Imsa Mf 1200 BBLL
(working size) CNC Selca 3040 d – axes: x 2000 y 1000 w 600 z 2400 – boring axes: 1200 dia. 40 max
- Nr. 1 NC drilling machine Foratrice Imsa Mf 1500 BBLL
(working size) CNC Selca 3040 d – axes: x 2000 y 1000 w 600 z 2400 – boring axes: 1500 dia. 60 max
- Nr. 1 Radial drilling machine INVEMA
(working size) mm 250 x 200
- Nr. 1 Parallel Lathe
(working size) mm 250 x 2000
- Nr. 3 Wire welding machine for steel and aluminium
- Nr. 1 Mould test press machine
(working size) mm 2500 x 1250 x max light mm 1850



ci/esse

Via Marsala, 34 - 20052 Monza (Mi) ITALY

Tel. :+39/039/2007881

Fax :+39/039/2006145

Web : www.ci-esse.com

E-mail : l.antonelli@ci-esse.com

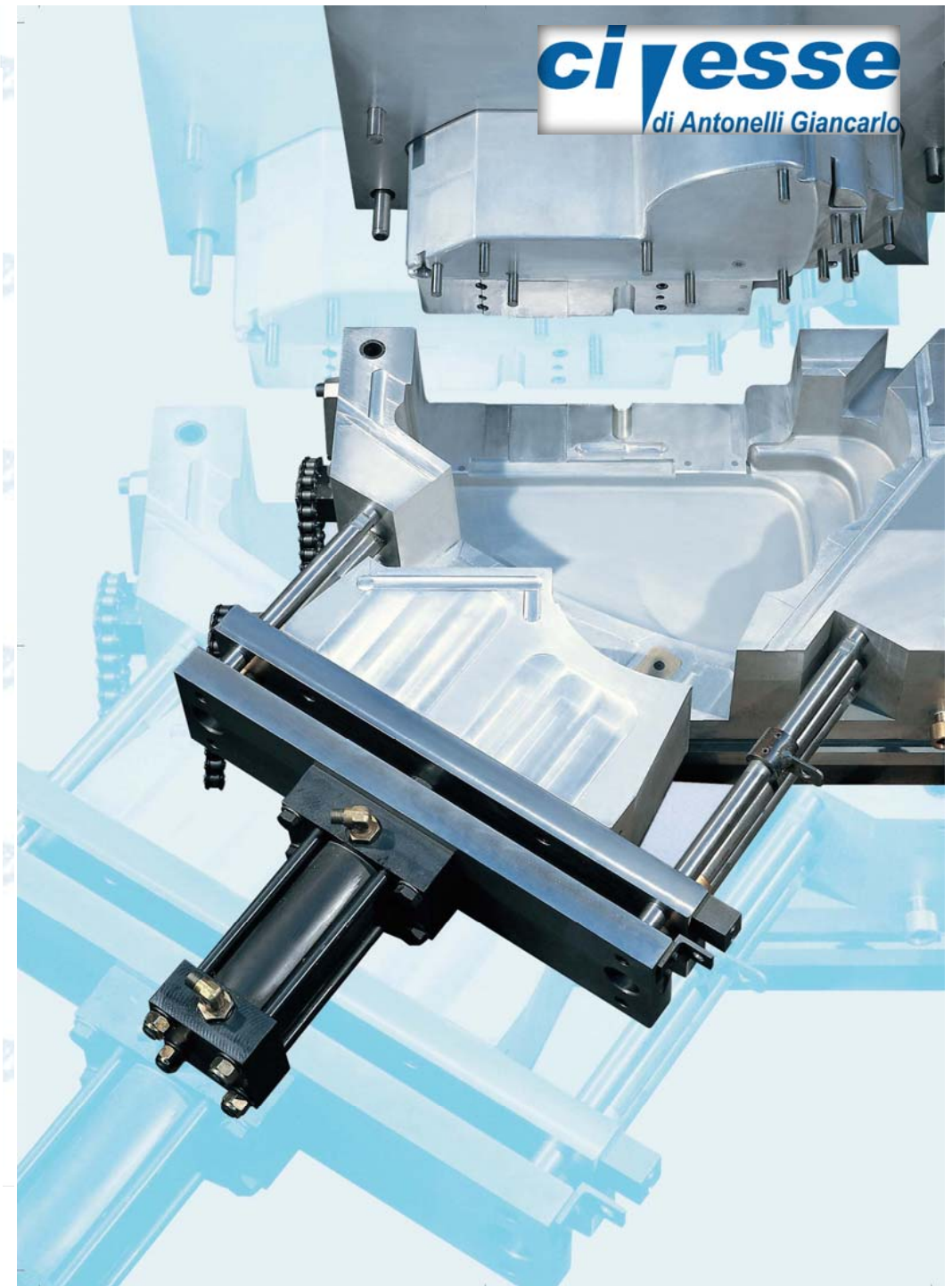

MACHINES



MACHINES



MACHINES

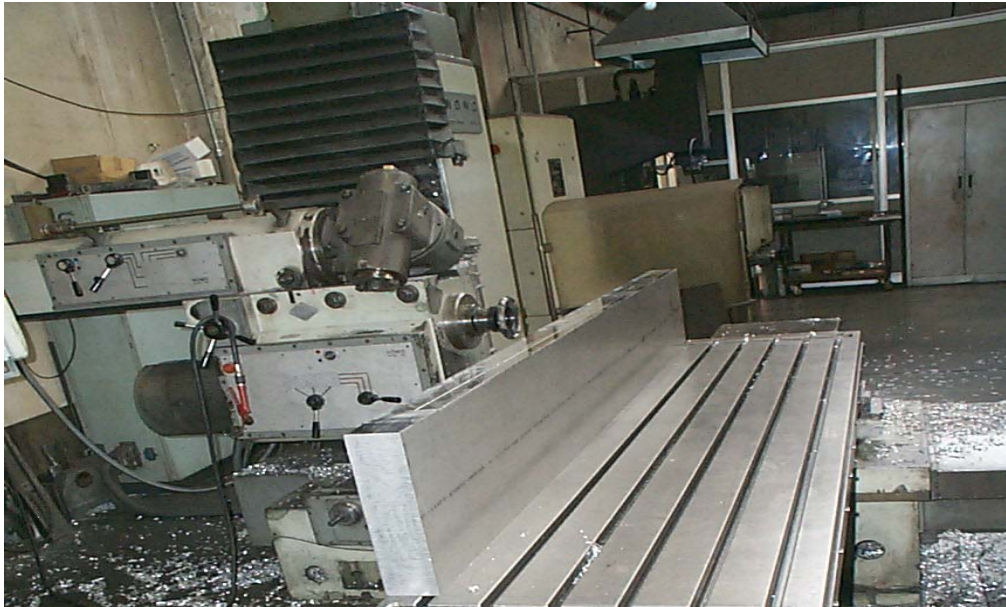

MACHINES

